

INSTRUCTIONS:

1. Submit 3 copies of this completed form, 3 copies of site plan and Homeowners' Association approval (if required). (Example of site plan available at Building Department.)
2. Complete a building permit application form.
3. Obtain approvals from Planning and Building Departments.

PATIO COVER SPAN TABLES

LATTICE PATIO COVER RAFTER SPANS (MAX) DF NO. 2					
Size	Spacing (inches o.c.)				
	16	24	32	36	48
2X4	9'-9"	8'-7"	7'-9"	7'-6"	6'-9"
2X6	15'-4"	13'-6"	12'-2"	11'-9"	10'-8"
2X8	19'-2"	17'-9"	16'-1"	15'-6"	13'-9"

SOLID PATIO RAFTER SPANS (MAX) DF NO.2		
Size	Spacing (inches o.c.)	
	16	24
2X4	7'-7"	6'-8"
2X6	12'-0"	10'-6"
2X8	15'-10"	13'-9"
2X10	20'-2"	17'-6"
(2)2X4	15'-2"	13'-4"
(2)2x6	24'-10"	21'-0"

LATTICE PATIO COVER HEADER SPAN (MAX)		
Size	DF NO.1	DF NO.2
(2)2X6	9'	8'
(2)2X8	12'	11'
(2)2X10	14'	13'
(2)2X12	17'	16'
4X6	10'	9'
4X8	13'	12'
4X10	16'	15'
4X12	18'	17'

SOLID PATIO COVER HEADER SPAN (MAX)		
Size	DF NO.1	DF NO.2
(2)2X6	7'	6'
(2)2X8	9'	8'
(2)2X10	11'	10'
(2)2X12	13'	11'
4X6	8'	6'
4X8	10'	8'
4X10	12'	10'
4X12	14'	12'

NOTES:

- A. The longest wall and one additional wall shall have a minimum open area equal to 65% of the wall area below 6'-8"
- B. Openings may be enclosed with insect screening or plastic that is 1/8" max thick translucent or transparent which is readily removable (ie wingnuts).
- C. Such enclosures shall not obstruct bedroom egress (window or door) which is required to open onto a yard or exist court.
- D. 5'-0" minimum clearance is required between patio cover and pool or spa.
- E. Minimum concrete strength = 2500 psf @ 28 days.
- F. All pre-fabricated connectors shall be ICBO approved.

PATIO COVER DETAILS

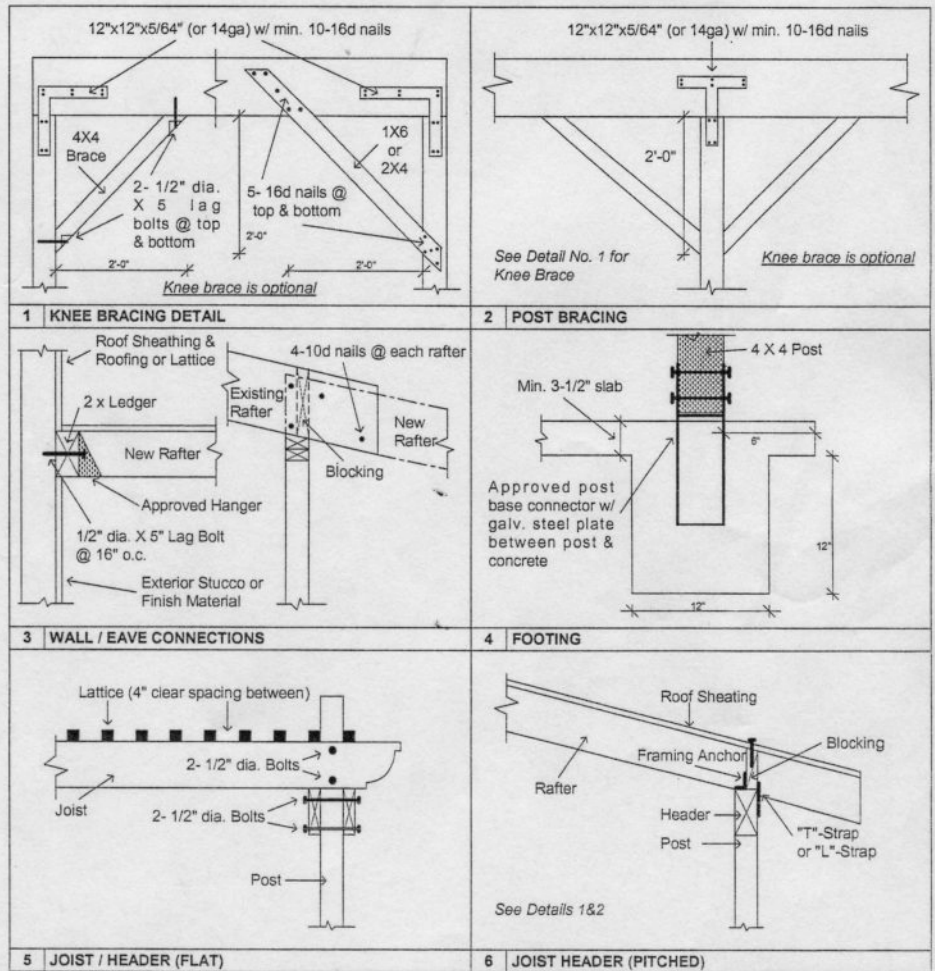

EXPIRATION

4/3/14

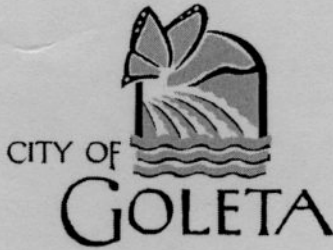

130 Cremona Drive, Suite 'B'
Goleta, CA 93117-3011
Building Department: (805) 961-7552
Inspection Line: (805) 961-7550

INSPECTION RECORD

ADDRESS: 138 VERONA AVENUE
 PERMIT #: 1300 DATE: 10/01/13
 DESCRIPTION: PATIO COVER

INSPECTION HOURS

**MONDAY through THURSDAY
9:00 AM TO 4:00 PM**

NO	INSPECTION	DATE	INSP.
REQUIRED BUILDING INSPECTIONS & APPROVALS			
B1	Location & setbacks		
B2	Soils engineer's approval		
B3	Foundation/trench forms		
B4	Structural concrete/slab on grade		
B5	Raised floor framing		
B6	Underfloor insulation		
B7	First level floor sheathing		
B8	Interior shear panel		
B9	Exterior shear panel		
B10	Roof sheathing		
B11	Pre-wrap		
B12	Frame inspection		
B13	Rough fire sprinklers		
B14	Insulation		
B15	Interior lath/drywall		
B16	Exterior lath		
B17	T-bar ceiling		
B18	Rated shaft construction		
B19	Lot drainage		
B20	Goleta Sanitation District		
B21	Goleta West Sanitation District		
B22	Goleta Water District		
B23	Santa Barbara County Fire Dept.		
B24	Environmental Health Department		
B25	Public Works Department		
B26	Air Pollution Control District		
B27	FINAL BUILDING INSPECTION	<u>12.19.13</u>	<u>DM</u>

REQUIRED MECHANICAL INSPECTIONS & APPROVALS			
M1	Rough mechanical		
M2	Fire dampeners/smoke dampeners		
M3	Smoke/ CO detection devices		
M4	Manufactured fireplaces		
M5	Commercial hoods		
M6	FINAL MECHANICAL INSPECTION		

NO	INSPECTOR	DATE	INSP.
REQUIRED ELECTRICAL INSPECTIONS & APPROVALS			
E1	Temporary power pole		
E2	System ground		
E3	Underground electrical		
E4	Rough wiring		
E5	Electrical service		
E6	Bonding water & gas		
E7	Solar panels		
E8	FINAL ELECTRICAL INSPECTION		
REQUIRED PLUMBING INSPECTIONS & APPROVALS			
P1	Underground/floor plumbing		
P2	Water service		
P3	Rough plumbing/topout		
P4	Sewer		
P5	Water heater		
P6	Backwater valve		
P7	Backflow device		
P8	Gas test		
P9	Gas final		
P10	FINAL PLUMBING INSPECTION		
REQUIRED SPA/POOL INSPECTIONS & APPROVALS			
S1	Spa/pool location & setbacks		
S2	Heater location & setback		
S3	Overhead conductor clearance		
S4	Underground plumbing		
S5	Electrical bonding		
S6	Steel reinforcements		
S7	Underground electrical		
S8	Gas test		
S9	P-trap/backwash receptor		
S10	Fencing & gates		
S11	Spa/pool cover		
S12	FINAL SPA/POOL INSPECTION		
REQUIRED GRADING INSPECTIONS & APPROVALS			
Compaction report received			
Supervising engineer's report received			
G1	Rough grading		
G2	Finish grading		
G3	FINAL GRADING INSPECTION		

NOTICE:

IT SHALL BE THE DUTY OF THE APPLICANT TO CAUSE THE WORK TO BE ACCESSIBLE AND EXPOSED FOR INSPECTIONS, TO INCLUDE A LADDER IN PLACE WHERE APPROPRIATE IE: ROOFING INSPECTIONS. NEITHER THE BUILDING OFFICIAL NOR THE JURISDICTION SHALL BE LIABLE FOR EXPENSE ENTAILED IN THE REMOVAL OR REPLACEMENT OF ANY MATERIAL REQUIRED TO ALLOW INSPECTION.

POST IN A LOCATION EASILY VISIBLE FROM THE PUBLIC RIGHT OF WAY

